



Rx ONLY

**DESCRIPTION OF PRODUCT:** Double padded mitt with inspection flap.

**INTENDED USE:**

- To protect patients assessed to be at risk of disrupting life-saving treatments (e.g., chronic tube pulling) or in danger of injury to themselves or to others by limiting hand movement.
- Follow your hospital's restraint policies and procedures that are compliant with USA CMS guidelines and state laws, or other governing agencies outside the USA.

**CONTRAINDICATIONS:** None

**APPLICATION INSTRUCTIONS:** (Repeat steps 1-3 for each mitt)

**NOTE:** Product is not designed for use with a connecting strap (visit [tidiproducts.com](http://tidiproducts.com)).

1. Insert the patient's hand into the mitt, palm down. When the inspection flap is open, the back of the hand should be visible (Fig. 1).
2. Wrap the wrist strap around the smallest part of the patient's wrist, and secure with the hook-and-loop fastener.
3. Slide ONE finger (flat) between the mitt and the inside of the patient's wrist to ensure proper fit. The strap must be snug, but not compromise circulation.



**TO VIEW HAND/FINGERS:**

4. Reach under the inspection flap, detach the hook-and-loop fastener, and pull back the flap to expose the hand.
5. To close the inspection flap, tuck into the end of the mitt and press the hook-and-loop closure together firmly.

**PRECAUTIONS:**

- A clinical assessment and decision are required when used with monitoring lines or if patient has a wound or dislocated/fractured limb.
- Ensure that mitts are properly secured. If applied too tightly, circulation will be restricted; if applied too loosely, the patient may be able to slip his or her limb from the device.

**CAUTION:** RX Requirements.

Certain types of hand mitts can be considered a restraint. Pinning or otherwise attaching those same mitts to bedding or using a wrist restraint in conjunction with the hand mitts would meet the definition of restraint and the RX requirements would apply. Refer to USA CMS Interpretive Guidelines 482.13(e).

*Product not made with natural rubber latex.*



**POSEY PEDIATRIC PEEK-A-BOO MITT:**

<b>REF 2911S</b>	Infant, Cloth Peek-A-Boo Mitt, Double Padded, Small
<b>REF 2911M</b>	Toddler, Cloth Peek-A-Boo Mitt, Double Padded, Medium
<b>REF 2911L</b>	Youth, Cloth Peek-A-Boo Mitt, Double Padded, Large

**WARNING:** Additional or different body or limb restraints may be needed (visit [tidiproducts.com](http://tidiproducts.com)):

- Some patients may require additional interventions in conjunction with this device in order to prevent injury to self or others.
  - To reduce the risk of the patient getting access to the line/wound/tube site.
- It is a clinical decision to decide when a restraint is no longer deemed safe.

**BED SAFETY:** Refer to the Food and Drug Administration (FDA), or other governing agencies outside the USA, for the most recent Hospital Bed Safety Guidelines and the bed manufacturer's instructions for use.

EN

**ADDITIONAL SAFETY AND LAUNDERING INSTRUCTIONS ON OTHER SIDE.**



**For RX PRODUCTS ONLY.** Federal law (USA) restricts RX devices to sale by or on order of a physician. For use in a licensed healthcare facility only.

**STAFF TRAINING:** TIDI offers in-service training aids at no charge. Contact TIDI online at [www.tidiproducts.com](http://www.tidiproducts.com) or call toll-free at 1.800.521.1314.

**BEFORE APPLYING ANY RESTRAINT:** Follow your hospital's restraint policies and procedures that are compliant with USA CMS guidelines and state laws or other governing agencies outside the USA.

**⚠️ ADDITIONAL WARNINGS:**

1. ALWAYS monitor patient per facility policy. Improper application or use of any restraint may result in serious injury or death. Be aware that constant monitoring may be required for:
  - Aggressive or agitated patients; and
  - Patients in a supine position; ensure that being in this position would not cause any complications for those who are at risk of vomiting while being restrained.
2. NEVER alter or repair this product. ALWAYS inspect before each use: Check for broken stitches or parts; torn, cut or frayed material; or locks, buckles, or hook-and-loop fasteners that do not hold securely. DO NOT use soiled or damaged products. Doing so may result in serious injury or death. Dispose of damaged products per facility policy for BIOHAZARDOUS material.
3. ALWAYS secure straps to a part of the frame that moves with the patient (not foot/head board or siderails), out of the patients reach, using quick-release ties (see drawing below) or buckles. These allow easy release in the event of an accident or fire. Test to make sure straps cannot tighten, loosen, or slip and create excess slack. If this occurs, the patient may slide off the chair or bed, increasing the risk of serious injury or suffocation. Restraint release is an important part of facility fire and disaster drills. Straps can be cut with scissors in an emergency.
4. NEVER secure restraint strap to side rail or head/foot board.
5. NEVER use Posey products on toilets, or on any chair or furniture that does not allow proper application as directed in the Application Instructions. DO NOT use at home.
6. NEVER expose this product to open flame, fire, smoking materials, or high heat sources. Some products may melt or ignite and burn. The facility smoking/no smoking policy should be strictly enforced.
7. NEVER use a Posey product as a seat belt in a moving vehicle. Posey products are not designed to withstand the force of a crash or sudden stop.
8. Test Zippers or hook-and-loop fasteners before each use. DISCARD device if it does not fasten securely.

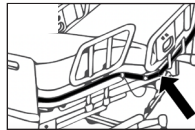

**LAUNDERING INSTRUCTIONS** (if applicable):

- Fasten all buckles and locks to reduce risk of damage during wash and dry cycles. DO NOT put buckles or locks through extractors. For maximum life, launder in a laundry bag.
- Stainless Steel Locks: Posey recommends that locks be treated with a dryfilm lubricant (silicone) after each cleaning. For best results, spray a small amount into the lock. Work the action of the lock with a key several times to ensure that all the surfaces are well lubricated.
- Before laundering, zip up and turn the product inside out to protect zipper.
- Hook-and-loop fasteners may collect lint after repeated use or laundering, reducing grip strength. Fasten the "hook" to the "loop" before laundering to help prevent lint buildup. As needed, use a stiff-bristle brush to remove lint from the "hook" side.

• These products, other than foam products, can be machine washed under CDC guidelines for material soiled with blood or bodily fluid.

160°F / 71°C WASH HOT 25 MIN.    BLEACH AS DIRECTED ON CONTAINER    DRY ON LOW

- For non-contaminated material, use lower temperature wash and dry cycles to extend product life.

• For foam products:

100°F / 38°C WASH LUKEWARM    BLEACH AS DIRECTED ON CONTAINER    DRY ON LOW

- Make sure products are completely dry before use.

**STORAGE AND HANDLING:**

- This device is designed for use in normal indoor environments.
- This device may be stored in ambient warehouse temperatures at normal humidity levels. Avoid excess moisture or high humidity that may damage product materials.

**HOW TO TIE THE POSEY QUICK-RELEASE TIE**

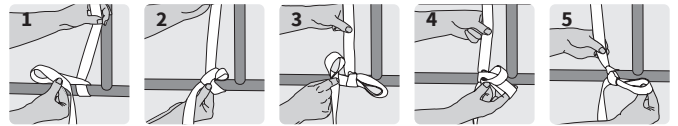

1. Wrap strap once around the frame that moves with the patient (do not attach to side rail or head/footboard), leaving at least an 8" (20 cm) tail. Fold the loose end in half to create a loop and cross it over the other end.
2. Insert the folded strap where the straps cross over each other, as if tying a shoelace. Pull on the loop to tighten.
3. Fold the loose end in half to create a second loop.
4. Insert the second loop into the first loop.
5. Pull on the loop to tighten. Test to make sure strap is secure and will not slide in any direction.
6. Repeat on other side. Practice quick-release ties to ensure the knot releases with one pull on the loose end of the strap.

**DISPOSAL:** Dispose of product according to local or facility guidelines if product is worn or damaged.